



# Mulch Pot Planter Model 1265

Assembly and Operating instruction with parts list and spacing

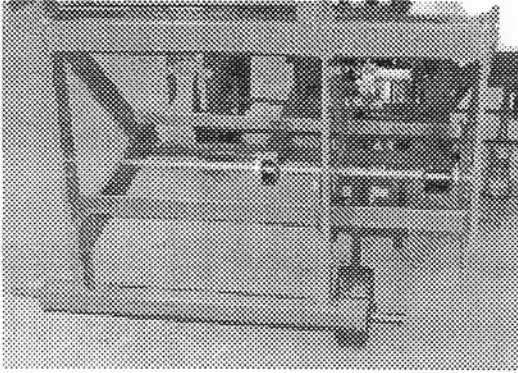

PHOTO SHOWS PLANTER WITH STANDARD SINGLE WHEEL DRIVE AND IDLER WHEEL, AND OPTIONAL FULL TOP TRAY

## LIST OF PARTS AND SUB-ASSEMBLIES NEEDED FOR MODEL 1265

- \*Unit main frame, with potholder spades, front stand and rear axle.
- \*Rear drive wheel. (two for dual wheel drive)
- \*Idler wheel with upright. (only with single wheel drive)
- \*7/8 drawbar shaft.
- \*3 pt. hitch or tool bar hitch.
- \*Two pot carrying trays and two pair of tray support brackets.
- \*Two tray bracket stabilizer bars.
- \*Two knee guard bars.
- \*Mulch sled
- \*Two fiber glass seats and seat support brace.
- \*Two packing wheels mounted on cross tube.
- \*Two pivot arms for packing wheels.
- \*Drive chain.
- \*One bag of misc. bolts.
- OPTIONAL EQUIPMENT**
- \*Water valve.
- \*Watering system barrel, brackets, straps, hose & clamps.
- \*Top tray, for extra plant carrying capacity, with two tray brackets.
- \*16" gauge wheels with tapered bearings, to help control planting depth.
- \*Offset 3 pt. hitch, for planting twin rows, 7 to 22 inches apart.
- \*Cat. II 3pt. hitch.
- \*Dual wheel drive, for extra traction and stability, in hilly and/or sandy soil.
- \*Row markers, for planting in bare ground.
- \*Cushion padded seats.

### 3 PT. OFFSET HITCH - Photo A



### IDLER WHEEL - Photo C

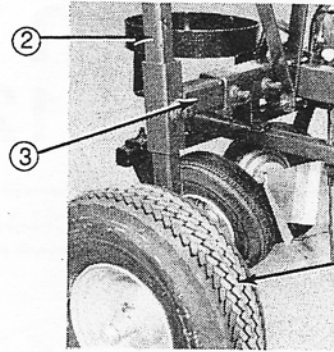

REF NO.	PART NO	DESCRIPTION
1	M-57	Rear idler wheel with 5:00 x 8 tire with 1" bearing.
2	M-58	Idler wheel axle upright (specify size - 7/8" or 1" axle)
3	M-58A	Horizontal adjustable tube for axle upright.

### REAR AXLE DRIVE-WHEEL

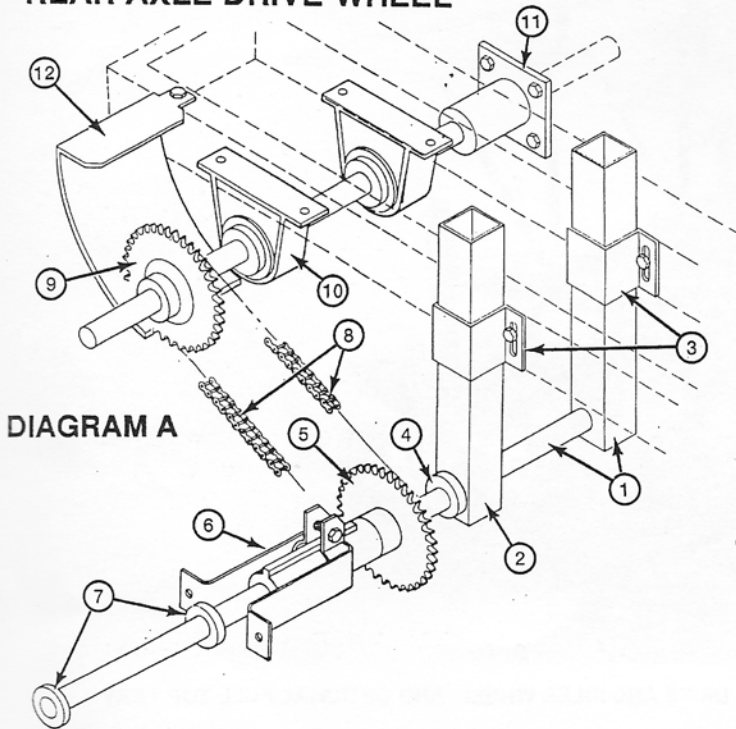
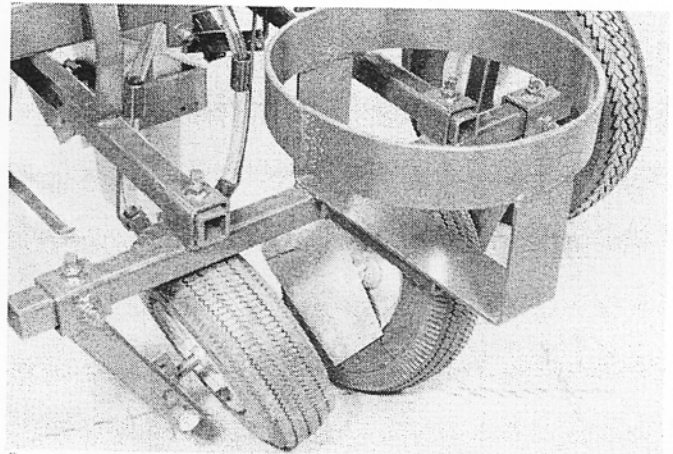

DIAGRAM A

### PACKING WHEELS - Photo D



REF NO	PART NO	DESCRIPTION
1	M-88	Rear axle with welded support tube.
2	M-89	Outside axle support tube
3	M-51	Support tube clamps
4	M-416	Collar for rear axle
5	M-53	Axle drive sprocket
6	M-54	Drive socket wheel bracket
7	#348A	1-1/2" cast iron collar
8	M-48A	Double pitch drive chain (#2050)
9	M-47	Disc shaft sprocket
10	M-46	Disc shaft bearing
11	M-45	Disc shaft with hub plate
12	M-99	Chain sprocket guard (Left side)
	M-99R	Right side chain sprocket guard for dual wheel model

### DRIVE WHEEL - Photo B

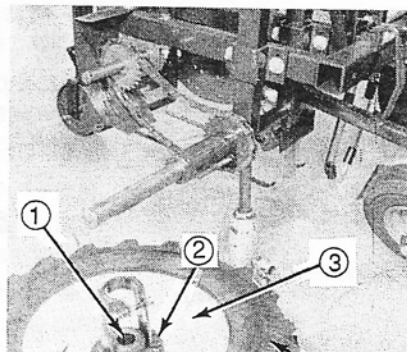

REF NO	PART NO	DESCRIPTION
1	P-130	Rear wheel roller bearing assembly - 1-1/2" bearing, sleeve, washers
2	1382	Wheel hub for rim
3	1381	15" drop center rim
4	M-69	6:70 x 15 traction grip tire

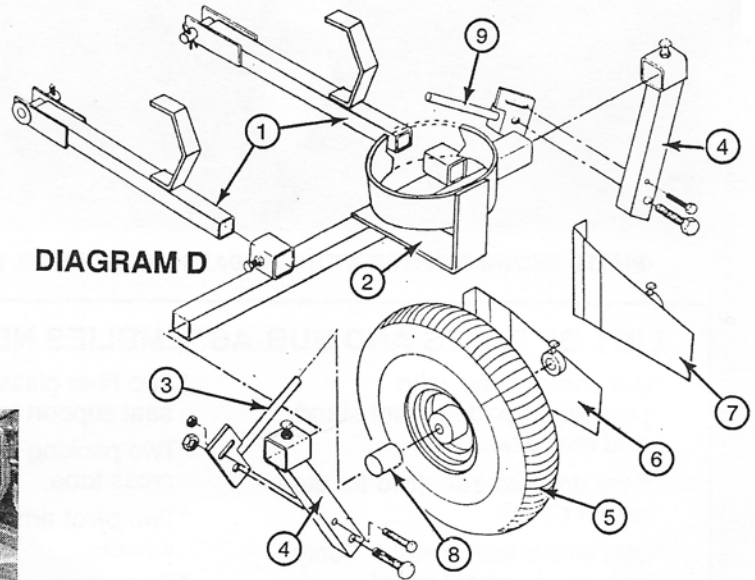

DIAGRAM D

REF NO	PART NO	DESCRIPTION	REF NO	PART NO	DESCRIPTION
1	M-64	Packing wheel pivot arm	8	M-65A	Packing wheel bearing 5/8" I D
2	M-61	Packing wheel weight bracket	9	M-92	Packing wheel axle - Right
3	M-93	Packing wheel axle - Left	M-62		Complete packing wheel assembly - Left side
4	M-91	Packing wheel bracket			includes: M-93, M-91, M-94 & M-95
5	M-94	Packing wheel with tire and bearings	M-63		Complete packing wheel assembly - Right side
6	M-95	Packing wheel guard - Left			Includes: M-92, M-91, M-94 & M-96
7	M-96	Packing wheel guard - Right			

## MODEL 1265 ASSEMBLY

The standard Model 1265 Mulch Pot Planter comes with a single drive-wheel mounted on the left side of the machine plus an idler wheel on the right side. A dual wheel drive model (shown below) is also available. NOTE: FOR PURPOSES OF THESE ASSEMBLY INSTRUCTIONS, THE RIGHT AND LEFT SIDE OF THE MACHINE IS DETERMINED AS IF YOU ARE STANDING BEHIND, LOOKING FORWARD, WITH THE MOUNTING HITCH BEING CONSIDERED THE FRONT.



### Step 1 - SET-UP

Open the crate and remove all parts wired to the crate and/or the unit. Make an orderly arrangement of all the loose parts, in groups, to match specific sections of the machine. Now remove planter frame from crate and place in a clear area.

### Step 2 - ATTACHING HITCH See photo A

Attach the hitch to the front end of the frame using the 7/8" drawbar shaft and secure with cotter keys. (photo A) The rear, bottom cross bar must be below the main frame. Now attach hitch to tractor.

### Step 3 - REAR AXLE DRIVE-WHEEL

See Diagram A and Photo B

Remove the left rear axle (1) from the unit frame. Slide the two square axle support tubes (1 & 2) up from the bottom of the clamp. Place the drive chain (8) around the axle drive sprocket (5) and the disc sprocket (9). Bolt the drive sprocket bracket (6) to the hub of the wheel. Tread on tire should be opposite direction of tractor rear tire. Place the wheel, with the drive sprocket bracket attached, on the axle. As shown in diagram A, put the collars (7) on axle to hold wheel in place. Snug up all bolts but do not wrench tighten until you have finished with step 5. Recommended distances from bottom of frame is 18" on the back of the machine and 19" on the front. See photo G.

### Step 4 - IDLER WHEEL (SINGLE DRIVE-WHEEL MODEL ONLY) See photo C

In most cases, the idler wheel (1) and upright tube (2) are assembled as a unit, at the factory. It is "turned in" for shipping, to save space. Loosen the set screw, remove entire unit, turn it around and re-insert into the horizontal adjustment tube. Adjust sideways both the drive wheel and idler wheel to follow in the same tracks as the tractor wheels. This will give a more uniform planting depth for your plants. If your planter did not have the wheel and upright assembled, simply slide wheel on the axle and secure in place with cotter key, then attach to frame as described above.

### Step 5 - TAKE SLACK OUT OF DRIVE CHAIN

Position yourself behind the planter. Grasp the drive-wheel axle and pull toward you until the drive chain is tightened. Back off, leaving about 1/2" slack. DO NOT OPERATE WITH DRIVE CHAIN TIGHT. Tight chains will cause wheel slippage. AT THIS POINT TIGHTEN AND SECURE ALL BOLTS, INCLUDING REAR AXLE, DRIVE WHEEL AND IDLER WHEEL BOLTS.

### Step 6 - DUAL DRIVE-WHEEL (Optional)

For dual wheel models, repeat step 3 using right side drive-wheel. Reference numbers are exactly the same as a single drive model. Take up slack in both drive chains, as in step 5.

### Step 7 - PACKING WHEELS See Diagram D and Photo D

The packing wheel assembly attaches below the rear of the main frame. Attach the pivot arms to the bottom of the mainframe by inserting two 5/8" pivot pins through the square tubes on the main frame. Slide the pre-assembled packing wheel assembly onto the pivot arms (1) and tighten set screws. Adjust packing wheels for both the distance between them (plant clearance) as well as angle of slope (plant packing). We suggest you begin with the bottom of the wheels about 3" apart at a 60 degree angle. Make adjustments for your desired packing of soil once in the field. The weight bracket (2) is designed to hold a 5 gallon pail. Add soil in the pail until the right amount of weight is applied to the wheels to insure the desired amount of packing of soil around each pot.

## Step 8 - ATTACH SEATS

Attach seats to the support bar with the four bolts furnished for each seat. The only difference between the fiberglass (standard equipment) or the cushion seat (optional) is, the fiberglass has built in bolts while the cushion seat has nuts recessed into the seat frame.

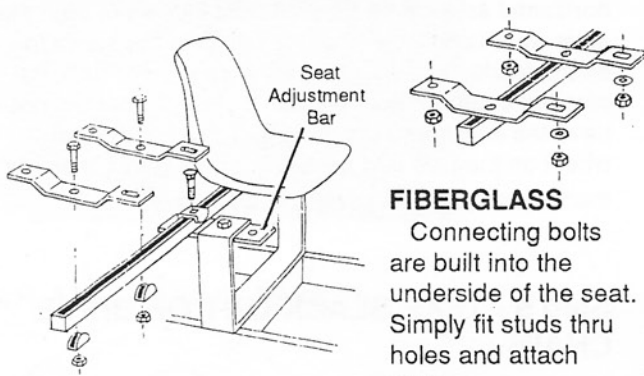

### FIBERGLASS

Connecting bolts are built into the underside of the seat. Simply fit studs thru holes and attach nuts.

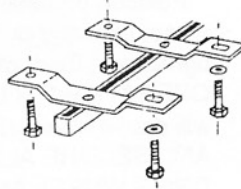

### CUSHION

Four cap screws go thru frame into recessed nuts.

### CAUTION

After installation (either seat) you must check for clearance between the back of the seat and the hitch. Raise planting unit and check for clearance. Seats can be moved by bolting through a different hole in the "Seat Adjustment Bar".

## Step 9 - POT CARRYING TRAYS

Photo E

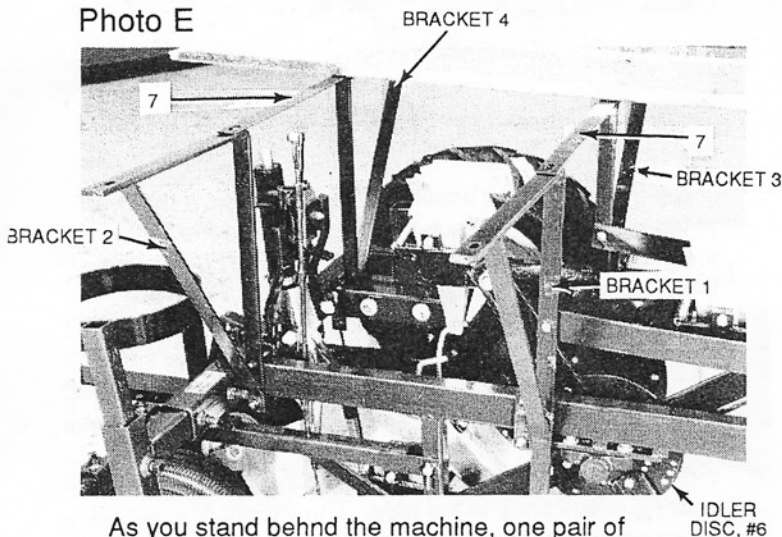

As you stand behind the machine, one pair of triangular shaped tray brackets (with short bolts - 1&2) attach to the right side of the main frame. The second pair (with long bolts - 3&4) attach to the left side. The two front brackets (1&3) attach just behind the bearing support of the Idler Disc (6). The two rear brackets attach just ahead of the rear frame member. Two 1/8 x 1-1/4 x 21" flat cross support bars (7) are positioned on top of the brackets. Line up the holes and attach with the same bolts that secure the two trays.

**NOTE: The dual wheel drive machine uses ALL long bolts on the tray brackets.**

## Step 10 - KNEE GUARD

Attach one knee guard on each side of the machine. This is a flat 2" x 1/8" x 23" long bar. One end is bolted to the front tray support brackets (1 and 3)(photo F). The other end is attached to the seat support bracket.

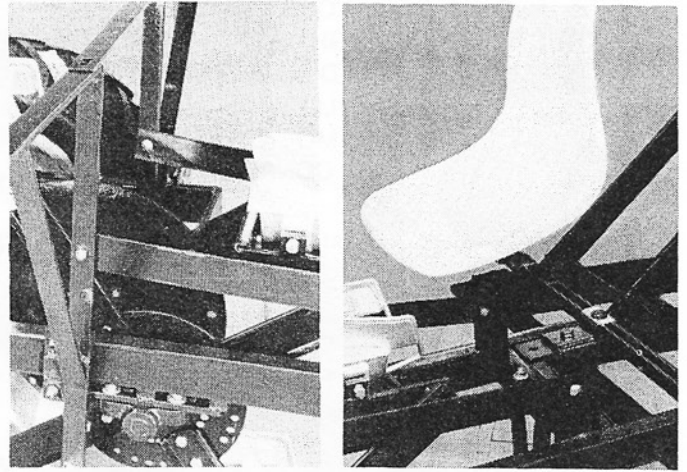
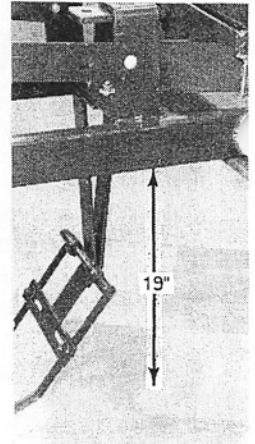

Photo F

## Step 11 - PLANTING DEPTHS Photo G

The depths pots are planted is controlled by the height of the frame above the drive-wheel. If you followed instructions in step 3 on the location of the drive-wheel axle, there should be approximately 18" from the bottom of the main frame to the planting surface. The front of the machine should be about 19" above bed or planting surface, (see photo G) The combination gives a slight uphill slant which is the recommended starting position.



## Step 12 - IN FIELD ADJUSTMENTS

Once planting begins, small changes in the desired planting depth of the plants can be done by raising or lowering the front of the machine with the tractor's hitch. Monitor the front of the machine with the tractor's hitch. Make regular checks to assure correct planting. Plants should not have pot showing above the ground, as this can cause wicking of the root ball which could result in plants drying out and dying.

## POCKET SPADES ASSEMBLY

## ROTATING DISCS TO HOLD POCKET SPADES

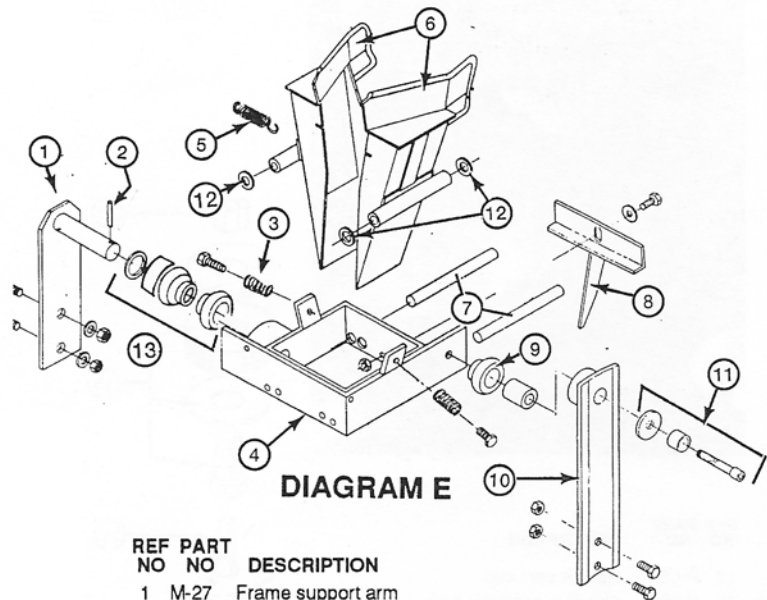

DIAGRAM E

REF PART NO NO	DESCRIPTION
1 M-27	Frame support arm
2 M-97	Retaining pin for arm
3 M-98	Closer adjustment spring
4 M-26	Holder frame with bearing
5 M-31A	Spade spring
6 -----	Pair of spades - see number & sizes below
7 M-31	Spade pivot rod
8 M-32	Mulch cutter
9 M-29	Idler arm bearing, with bushing
10 M-28	Idler arm
11 M-30	Idler arm bearing bolt, with valve trip.
12 M-9	Spacing adjustment washers
13 M-26A	Frame holder bearing (2 needed) - with shim

NOTE: M-25 Complete spade holder assembly

Includes:

1 - M-26	1 - M-30	1 - M-97
1 - M-27	2 - M-31	2 - M-98
1 - M-28	2 - M-31A	M-9
1 - M-29	1 - M-32	(Number needed varies)

Plus 1 set of spades - (designate size and number)

### NOT SHOWN

M-10P	Plastic insert, with bracket, for M-10 spade.
M-60	Mulch sled
M-60A	Mulch sled, rail only.

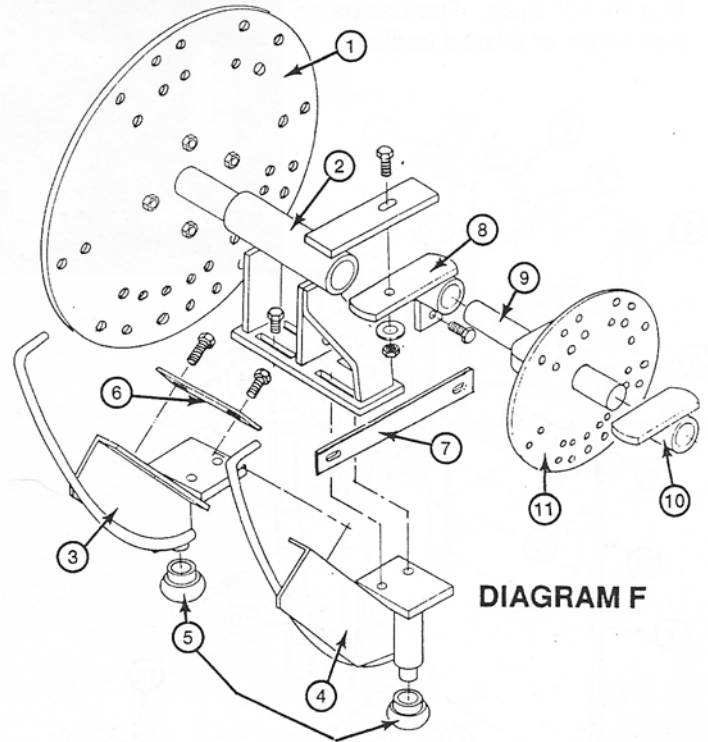

DIAGRAM F

### REF PART NO NO

DESCRIPTION
1 M-44 Support arm disc
2 M-38 Cam mounting bracket
3 M-36 Spade opening cam - Left
4 M-35 Spade opening cam - Right
5 M-101 Spade opening cam bearing only
6 M-37 Opening cam cross brace
7 M-39 Support base
8 M-40 Idler support bracket
9 M-42 Idler disc shaft
10 M-43 Disc shaft mounting
11 M-41 Idler disc

### NOT SHOWN

M-59	Front stand
1265AF	3 pt hitch
1265TB	tool bar hitch
1265BM	3 pt hitch with barrel mounting
1265BMO	3 pt offset hitch with barrel mounting
P-129-D	1 pair mounting brackets
FG	1 pair fiberglass seats, with brackets
CUS	1 pair cushion seats, with brackets

## SPADE SIZES

The 1265 Holland Pot Planter comes with 3 to 8 spade holders, depending upon planting spacing. However, there are a number of different sized spades available to accept your own particular size pots. The "spade holders" will accept any of the following sized pocket spades:

SPADE NUMBER	CELL OR POT SIZE	POT SHAPE	SPADE NUMBER	CELL OR POT SIZE	POT SHAPE
M-10	3/4"	Round or Sq.	M-12	1-1/2"-2"	Square
M-10A	1"-1-1/2"	Round or Sq.	M-13	1-3/4"-2-1/2"	Square
M-11	1-1/2"-2"	Round or Jiffy 7	M-14	1-3/4"-2-1/2"	Round
			M-15	2-1/2"-3-1/4"	Rnd. or Sq.
			M-16	4"	Rnd. or Sq.

## CHANGING POCKET SPADES

Remove present two part spade by first removing mulch cutter (8). Disconnect springs from top of spade. Insert punch into holes in back of holder frame (4) and tap out the pivot rods (7). CAUTION. Make sure you "catch" the spacing adjustment washers which are located between the holder frame and the pivot rod sleeves, attached to the pocket spade. Put new spade in using reverse order. IMPORTANT ADJUSTMENT. Make sure you use both adjustment screws and the spacing washers to "center" the spade in the holder frame. The spade must be centered from side to side within the holder, and bottom edges must be lined up and also flush with each other to get the right planting action. M-10 and M-10A spades use the inner set of holes, all other spades use the outside set of holes.

## MAINTAINING A BALANCE

The rotating discs(1 and 11, diagram F) on your 1265 Mulch Planter must always remain "in balance". Check chart below for correct number of spade holders required to get the distance between plants that you need. However, remember a minimum of 3 or 4 arms and holder frames are required to keep the planter running smooth and "in balance", and will help cushion any shock should you run into a rock or other hidden object which could otherwise cause damage. i. e. 42" and 84" spacing must have a minimum of 4 arms and holder frames.

## PLANT SPACING CHART

	Distance wanted between plants.										
	10 1/2"	12"	14"	17"	21"	24"	28"	34"	42"	56"	84"
No. of spade holders needed	8*	7**	6***	5	4	7	3	5	4	3	4
Location of spades											

You pick the spacing you want. We will attach spades to the disc to match the distance you request, per the drawings shown above.

\*The 8 holder machine is a special order, available only with M-10 or M-10A spades.  
 \*\*Not available with M-15 or M-16 spades.  
 \*\*\* Not available with M-16 spades.

## WATERING SYSTEM

Holland's special optional watering system is designed to give plants that important first shot of liquid. This can be just water, or a liquid fertilizer.

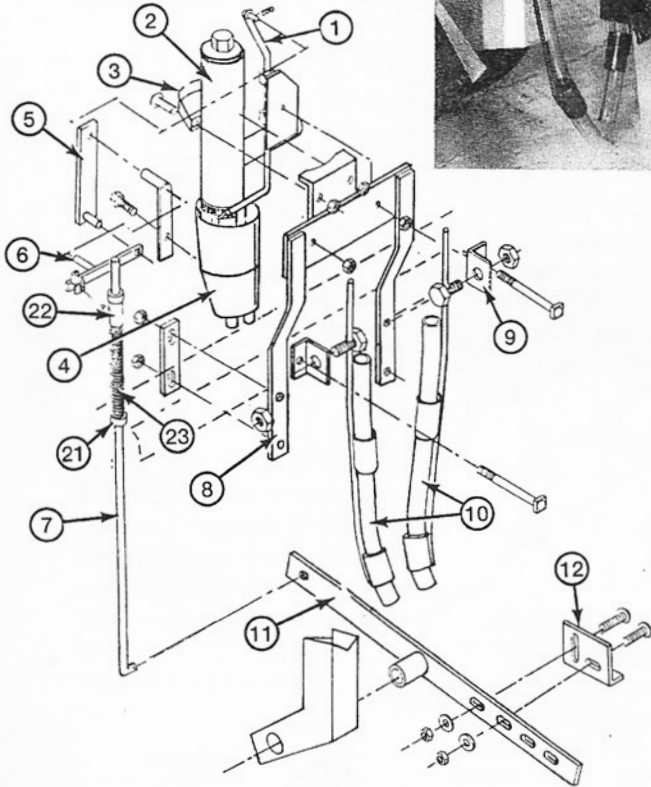
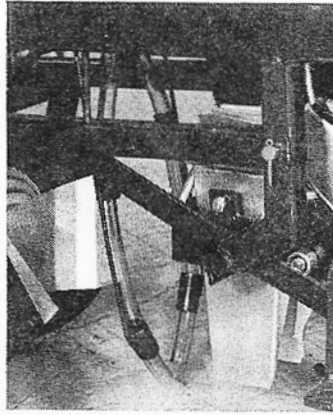

REF PART NO NO	DESCRIPTION
1 P-153-3	Control guide assy.
2 P-84	Water valve reservoir assy.
3 P-63	Valve reservoir clamp
4 M-80	Spout
5 M-76	Connecting link for rocker arm assy.
6 M-85	Rocker arm assy.
7 M-72	Adjustment rod
8 M-71	Valve mounting bracket
9 M-84	Adjustment plate for supply tube
10 M-82	Supply tube
11 M-86	Trip arm
12 M-83	Trip plate
21 M-73	Adjustment collar
22 M-75	Connecting tube
23 M-74	Cushion spring

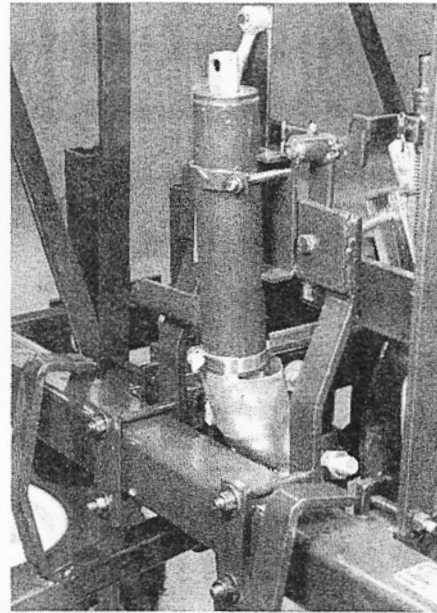
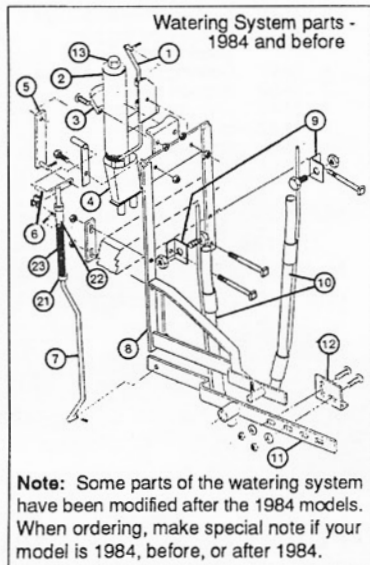

## WATER VALVE PARTS

REF PART NO NO	DESCRIPTION
13 P-151	Hex air vent cap
15 P-93	Air valve seat with both metal and rubber washer (P-93-A)
16 P-92	Male brass air valve
17 P-96	Ball float
18 P-95	Brass ball support
19 P-94	Lower rubber valve
20 P-87	Spout clamp

**NOTE:**  
M-70 Complete water valve includes Ref. No's 1 thru 21

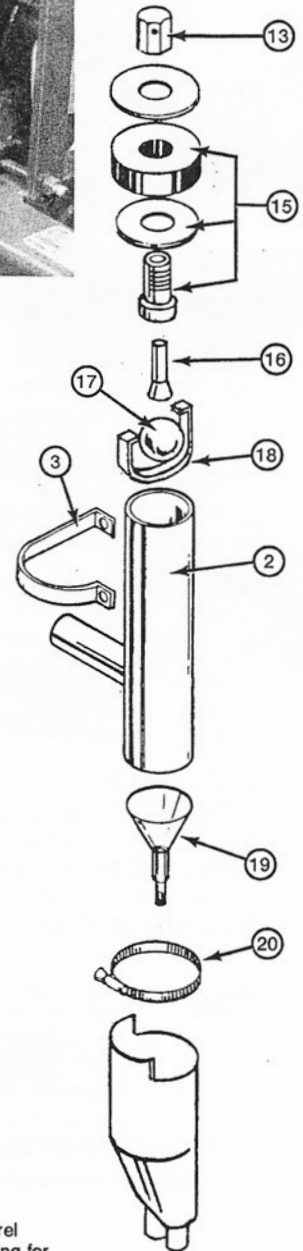

**NOT SHOWN**

P-133	Plastic hose
331	55 gallon barrel
LM	Barrel mounting for 3 pt. hitch



## HOLLAND TRANSPLANTER CO.

510 E. 16th St. / P.O. Box 1527 / Holland, MI 49422-1527 USA

3 miles west off I-196 (exit 52) OR 2 blocks west of U.S. 31 / 616-392-3579 FAX 616-392-7996

Leaders in the field since 1927